

Cadco High Performance Convection Oven Door Removal Instructions

(To attach the door, reverse the directions, starting with Step 3)

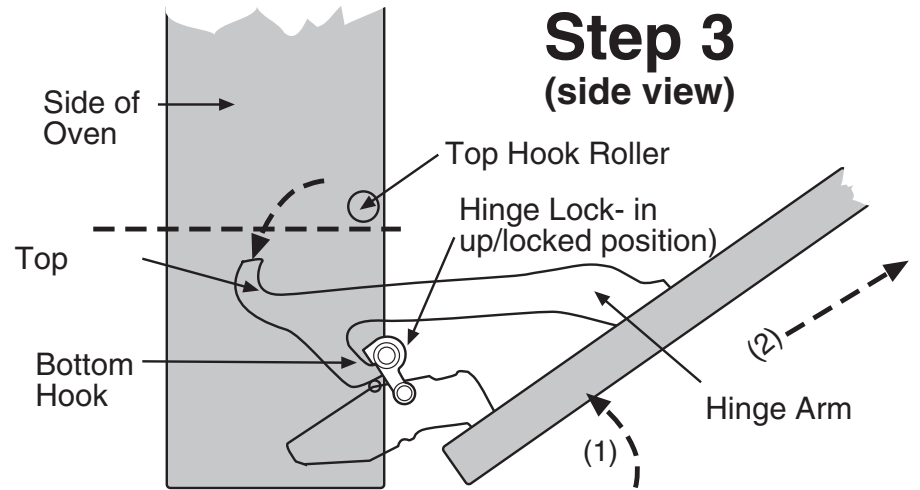
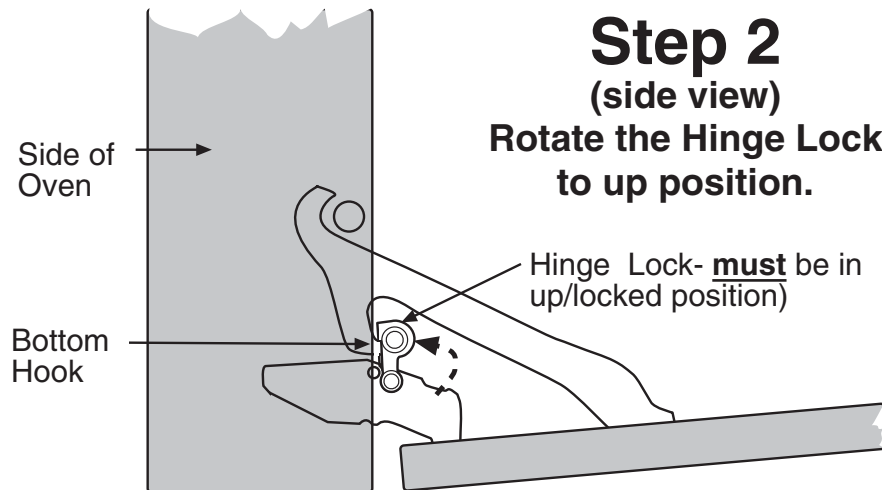
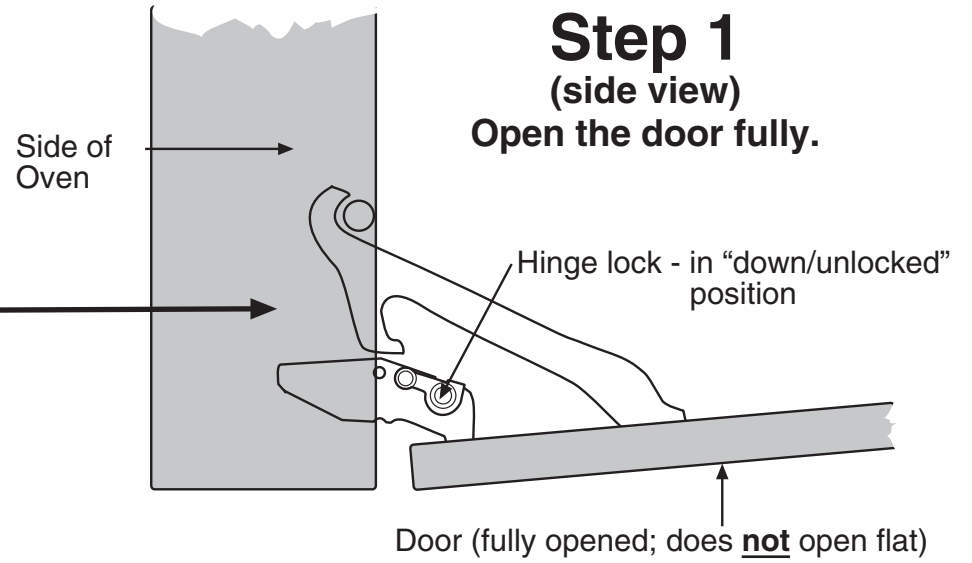
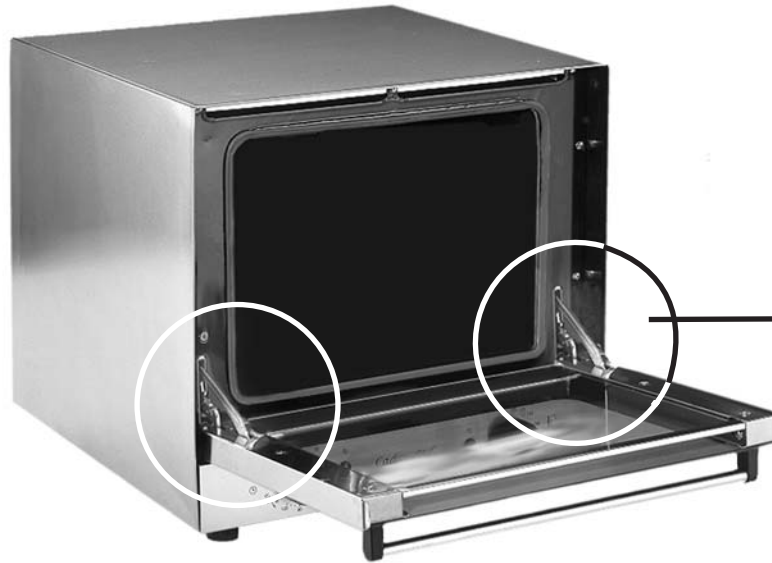

- 1) Tilt door up at about 45° angle until the Top Hook on the Hinge Arm is lower than the Top Hook Roller,
- 2) then pull out of the Hinge Slots.

PLEASE NOTE: Hinge Locks may become jostled into the unlocked position by rough handling of the carton during shipping, causing the door to be unhinged from the oven when the carton is opened. If this occurs, follow the directions for attaching the door.